

Merlin IV

First Choice in Cold Drink Vending



QUALITY • INNOVATION • SERVICE

Merlin IV

FIRST CHOICE IN COLD DRINK VENDING

The Royal Vendors Merlin IV beats the competition with these advantages:

- Delivery Chute Sensor
- Direct Drive 24-Volt Delivery System
- Enhanced Electronics
- LED Display
- Programmable Options
- Vandal-Resistant Exterior
- Menu Style Programming
- Wide Columns
- High-Capacity Stack
- Superior Package Flexibility
- Lowest Weights Among Comparable Models
- Electronic Refrigeration



RVCDE 542
Narrow Cabinet

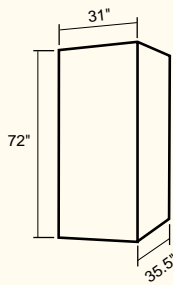

RVCDE 650
Standard Cabinet

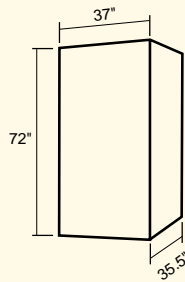

RVCDE 768
Standard Cabinet

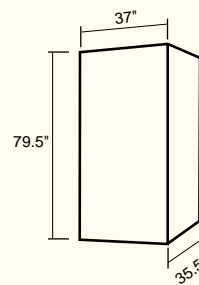

RVDVE 650
Standard Cabinet

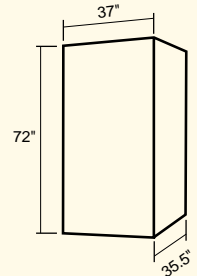

Columns:

10

12

12

12

Selections:

8

10

10

10

***Weight:**

550 lbs.

620 lbs

648 lbs.

620 lbs.

***Width:**

31"

37"

37"

37"

***Depth:**

35.5"

35.5"

35.5"

35.5"

***Height:**

72"

72"

79.5"

72"

CAPACITIES:

approximate, depending upon exact package size and shape

12 oz. Can:

Total	per column
540	54

Total	per column
648	54

Total	per column
768	64

Total	per column
648	54

20 oz. Bottle:

240	24
-----	----

288	24
-----	----

348	29
-----	----

288	24
-----	----

16/20 oz. Glass:

230	23
-----	----

276	23
-----	----

336	28
-----	----

276	23
-----	----

****16.9 oz Water:**

290	29
-----	----

348	29
-----	----

432	36
-----	----

348	29
-----	----

****1 Liter Plastic:**

170	15
-----	----

204	15
-----	----

228	17
-----	----

204	15
-----	----

**Kits may be required for proper vending

*Weights and dimensions rounded to closest whole number

QUALITY • INNOVATION • SERVICE

*Coca Cola® is a registered trademark of the Coca-Cola Company.
*Pepsi-Cola® is a registered trademark of the PepsiCo, Inc.



Royal Vendors, Inc.
Bardane Industrial Park
201 Industrial Boulevard
Kearneysville, WV USA 25430



P: 304-728-7056
P: 800-321-8637
F: 304-725-4016
www.royalvendors.com

833,050,00P 11/00